

NMSC

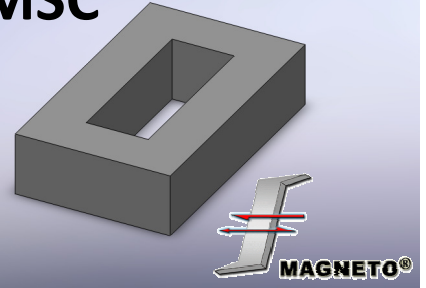

Nanocrystalline Magnetic Stack Cores

Product name	A (mm)	B (mm)	C (mm)	D (mm)	E (mm)	F (mm)	Mean magnetic path length (mm)	Cross section (mm ²)	Mass (kg)
NMSC 260x160-55	55	50	150	160	260	20 – 100	620	50 x F	3.8 – 18.9
NMSC 245x155-55	55	45	135	155	245	20 – 100	580	50 x F	3.5 – 17.7
NMSC 210x135-45	45	45	120	135	210	20 – 100	510	40 x F	2.5 – 12.7
NMSC 195x130-45	45	40	105	130	195	20 – 100	470	40 x F	2.3 – 11.7
NMSC 175x110-35	35	40	105	110	175	20 – 100	430	30 x F	1.7 – 8.3
NMSC 165x110-35	35	40	95	110	165	20 – 100	410	30 x F	1.6 – 8.0
NMSC 145x100-30	30	40	85	100	145	20 – 100	370	25 x F	1.2 – 6.2
NMSC 145x95-30	30	35	85	95	145	20 – 100	360	25 x F	1.2 – 6.0
NMSC 140x75-25	25	25	90	75	140	20 – 100	330	20 x F	0.9 – 4.6
NMSC 135x75-25	25	25	85	75	135	20 – 100	320	20 x F	0.9 – 4.4
NMSC 110x60-20	20	20	70	60	110	20 – 100	260	15 x F	0.6 – 2.9
NMSC 95x55-20	20	15	55	55	95	20 – 100	220	15 x F	0.5 – 2.4

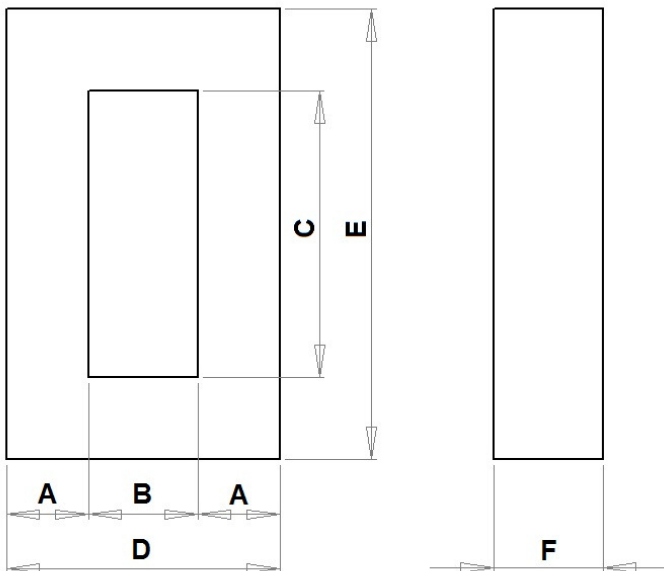

Magneto Ltd.
 Odlewnikow 43 street
 42-202 Czestochowa
 POLAND

Tel./Fax +48 34 360 22 72
 e-mail rdzenie@magneto.pl
www.magneto.pl